

- General Notes:**
- Concrete - 5,000 PSI
 - HS20 Wheel Load Design
 - Sumps & Pulling irons by Penn Insert
 - Joint Sealer - EZ-Stick
 - Optional Tremproof 60 Exterior Waterproofing
 - Pulling Irons - By Penn Insert w/ Plastic Cover
 - Reinforcement - #5 Bars @ 8" O.c.E.w. Grade 60 Plain Steel or WWF

Typ. Electric Vault
(8'-0" Wide x 8'-0" Long x 6'-6" Deep)

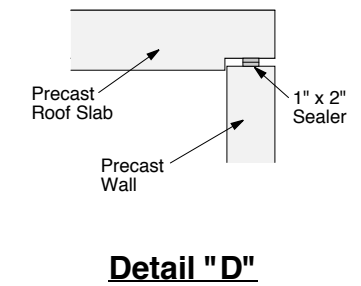

Crest Precast, Inc.
La Crescent, MN & Barneveld, WI
800-658-9045

Scale	Drawn By: KGT
Date	Revision
Project: 8 x 8 x 6'-6" Electrical Vault	Drawing Number
Contractor:	1