

Top View

- Notes:**
- ° 5,000 PSI Concrete
 - ° Reinforced with #6 Bars @ 12" O.C.E.W.
 - ° Security Door By GC. - Special Hinge & Latch System for FEMA Rating
 - ° All Exterior Joints Caulked
- Finishes:**
- ° Plain Gray
- Surface Finishes:**
- ° Smooth Form Finish

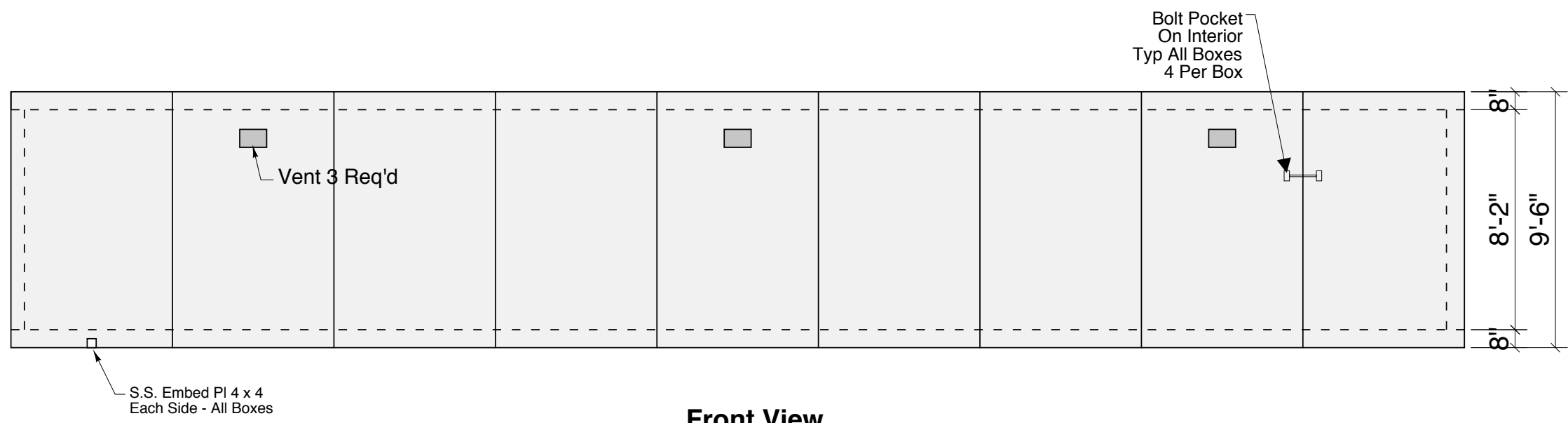

Front View

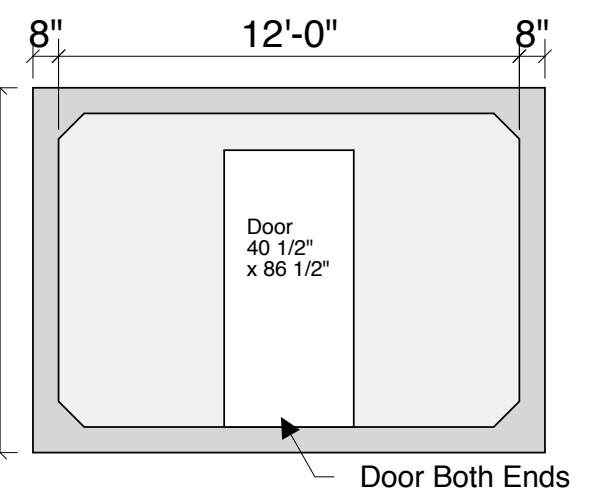

End View

Storm Shelter For Caterpillar

*Crest Precast, Inc.
La Crescent, MN & Barneveld, WI*