

Front Elevation

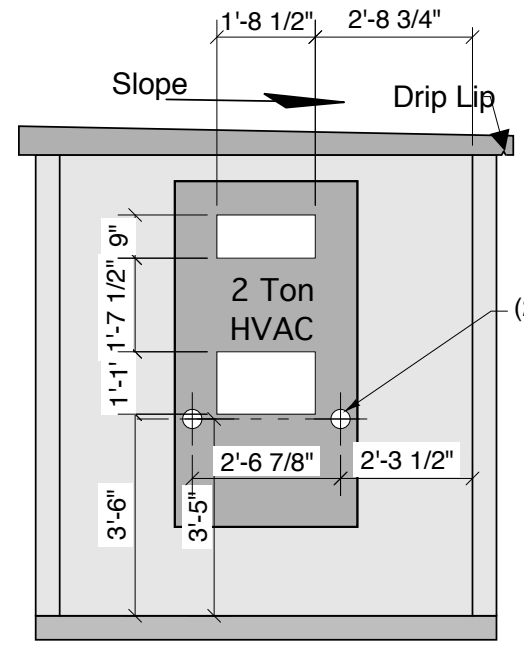

Right Side Elevation

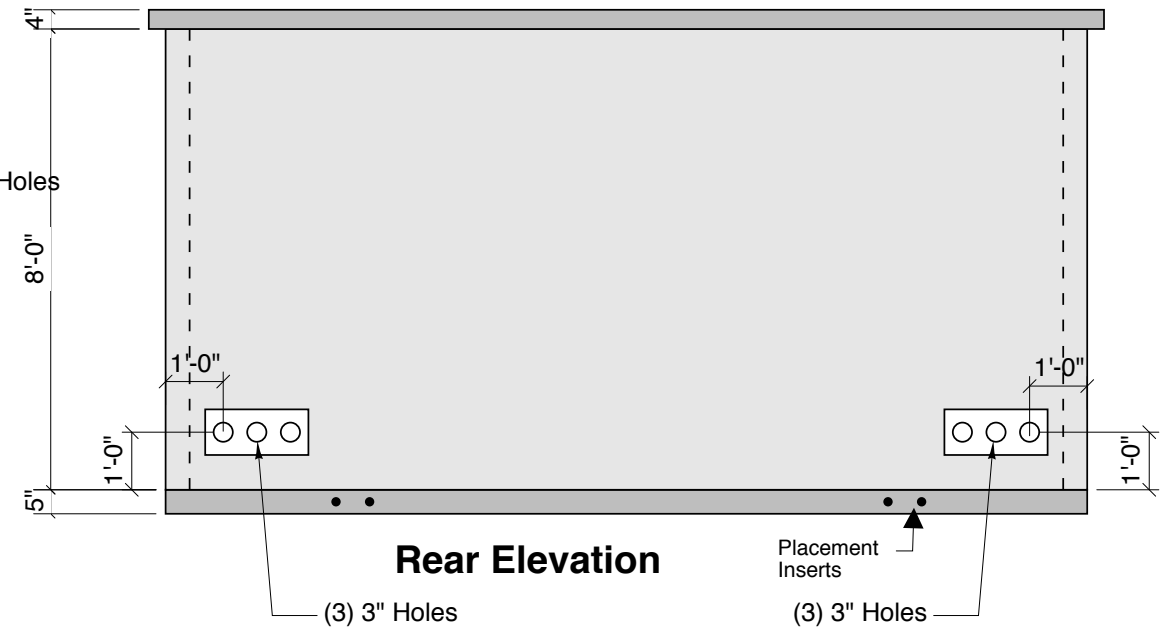

Rear Elevation

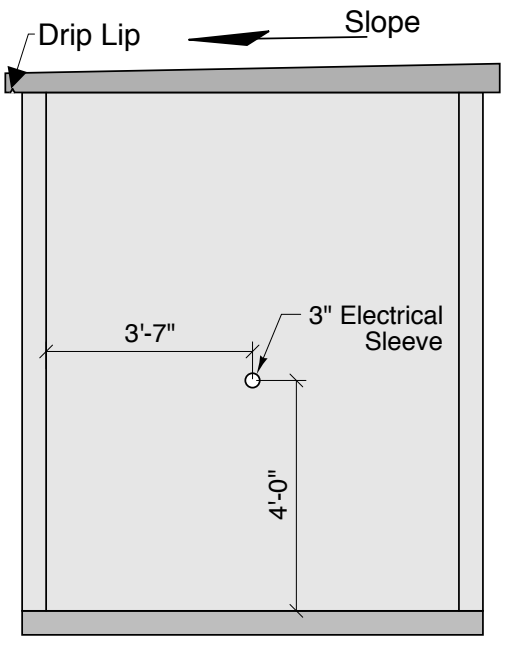

Left Side Elevation

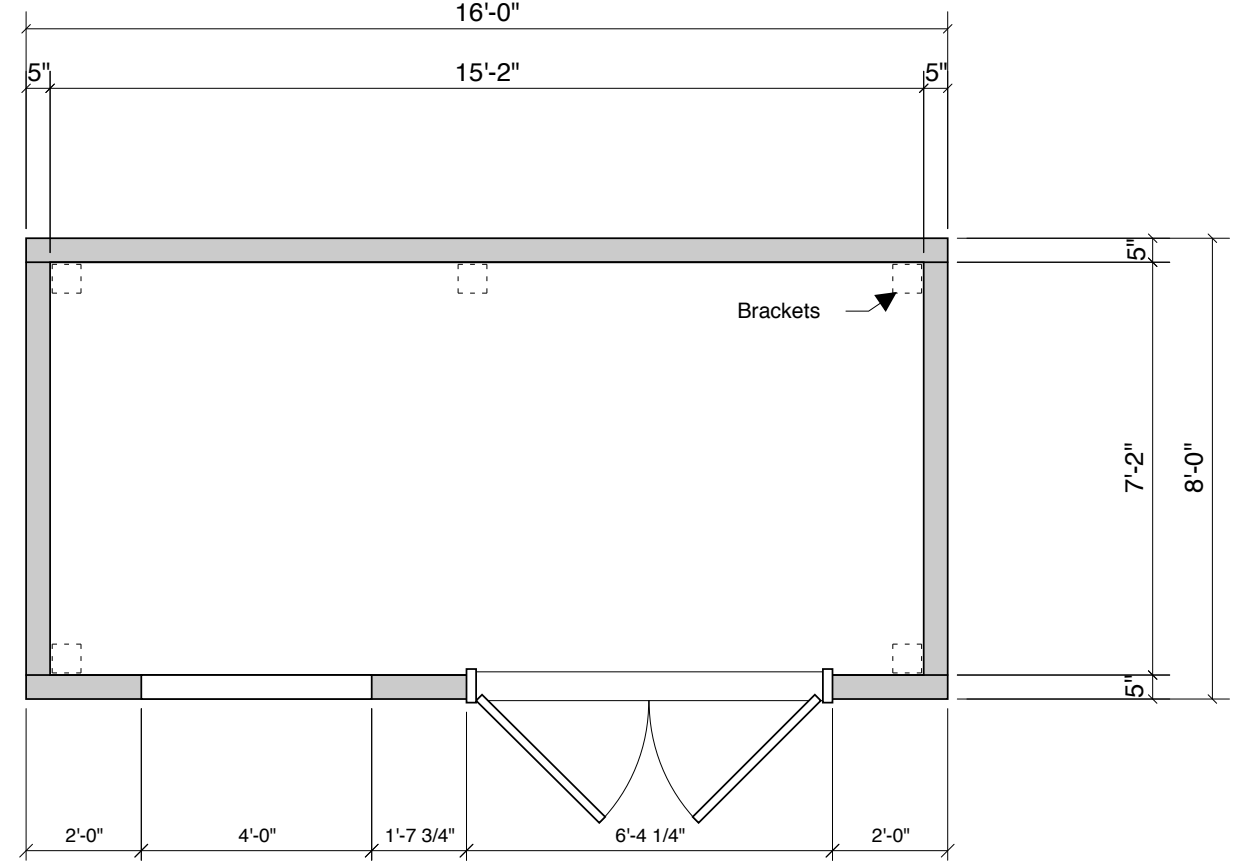

Floorplan

8'-0\"/>

Specifications:

- Interior Dimensions: 8'-0" x 16'-0" O.D.
- Concrete: Steel Reinforced 5,000 PSI
- Steel: Grade 60 Reinforcing Steel
- Finishes:
 - Inside - Smooth Concrete Surface
 - Exterior - Split Block
 - Door & Frame - Finished Painted (Forest Green)
- Doors: Honeycomb - core steel, double door, (2) 3'-0" x 6'-8" 16 Ga., dead bolt top & bottom
- Coat Exterior Walls With Clear Sealer - Cure Seal By Sonneborn or equal
- Roof Load: 60 PSF DL
- Floor Live Load: 250 PSF
- Wind Load: 130 MPH
- Dead bolt security lock with door handles optional
- Roof is pitched 2" front to back with a 3" overhang all around
- Panels are securely fastened together with bolts and steel clips or Welded Connections
- Footing / Stone Base to be minimum 6" thick x 10'-0" x 18'-0" or alternate surface is Concrete Or Asphalt.

Finish:

- Roof - Forest Green Concrete Stain
- Doors - Forest Green Mautz Enamel
- Walls - Light Brown/Tan Intergral Solomon Color @ 5 Lbs Per Yard #370 Brown

Warranty:

- 5 year weatherproof and 10 year structural

Crest Precast, Inc.
La Crescent, MN & Barneveld, WI
 800-658-9045

Scale	Drawn By: KGT
Date	Revision
Project: 8 x 16 Precast Building	
Contractor:	Drawing Number 1